

MINI TAG | TAG | MAXI TAG

ULTIMATE SAFETY AGAINST HALOGEN POLLUTION
FOR GASEOUS ANESTHESIA



All gaseous anesthesia tables designed by TEM SEGA are powerful scavenging stations with easy modular setup, for 1-4 users in totally safe conditions.

safety

Patent-design of TEM SEGA offer a **large scavenged working surface** protected by an **active filtration system**, **realtime filter saturation indicators** and **easy decontamination protocol**.

modularity

Each station set-up can be **configured in less than one minute** either for right-handed or left-handed users. With its **quick exchange system**, MAXI TAG enables perfect **working conditions for 4 users**.

productivity

TAG's user-friendly touchscreen allows to perform **short or long secured anesthesia protocols** and **optimized induction cycle**, to save time, isofluran and increase animal safety.

Your designer-manufacturer for all-in-one animal anesthesia solutions

Since 1992, TEM SEGA is the leading manufacturer in Europe of gaseous anesthesia devices for veterinarian purpose. Our device can be customized to fit many species from mice to horses, and drive all types of labs gas (air, oxygen, CO₂, Nitrogen and toxic gas). Our values are to offer the highest human and animal protection, improve productivity and precision in research labs, propose modularity and flexibility, and comply with ethic guidelines. Our technical team install, train and support everywhere in the world.

*Our equipment are complying with European and US regulation, AAALAC recommendations.

Technical specifications

The most polyvalent and secure tool for rodent anesthesia.

Control
Touchscreen

Mask with animal
presence sensor

Stainless steel plate
with heating system
and rectal probe for
thermoregulation

Gas mixing system
embedded: Air/O₂
or Air/CO₂

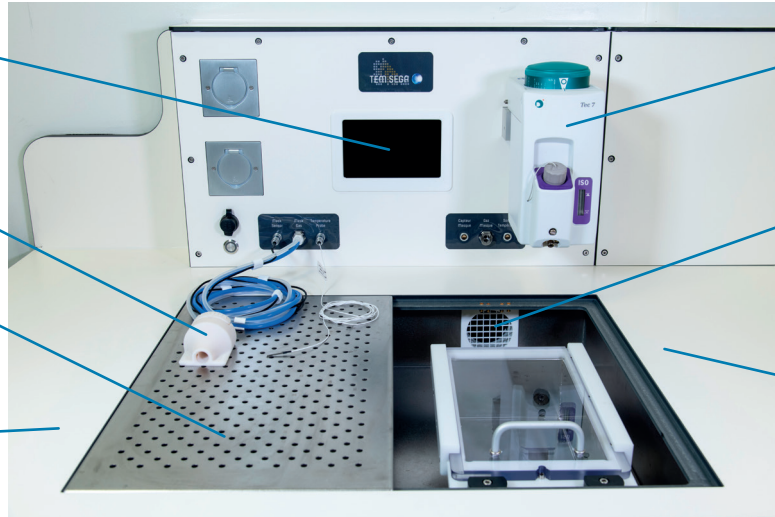

Exchange mounting
system for vaporizer
TEC3 or TEC850

Patented and certified
working area against
pollution (< 2 ppm)

from 2 to 4 working
independent stations
(MINI-TAG, TAG or
MAXI-TAG)

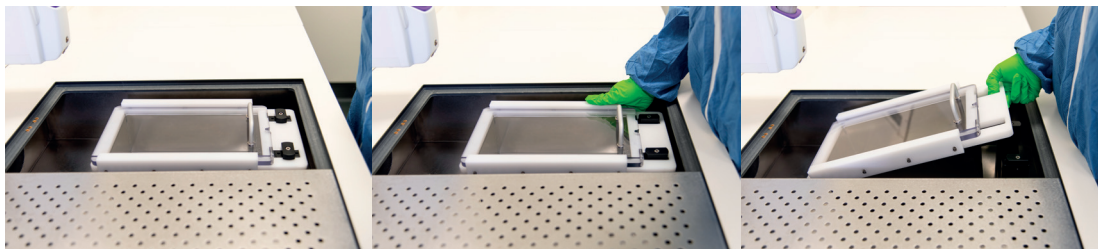

Induction chamber

With two simple clips, you can move the induction chamber to each station. `
Inside the housing, used gas are extracted by the powerful scavenger.
One cover sensor enables or disables the gas input.

Let's discover our TAG options

Available with 2, 3, 4 or 2x2 working stations, **TEM SEGA gaseous anesthesia tables can be customized to fit your needs.** Create your own-station to perfectly fit your request !

- > Embedded oxygen concentrator
- > Embedded air compressor
- > Active scavenging system with building connection
- > Retractable sides
- > Integrated Monitoring
- > Surgery LED lighting
- > transparent protection cover
- > Wheels or fixed

All our products are designed and manufactured in France, Please contact us at:

27 allée Charles Darwin
33600 Pessac - France

Tél. : 05 56 32 29 63
Fax : 05 56 32 29 43

info@temsega.com
www.temsega.com

TEM SEGA 
one touch device